

CECIL WRIGHT

FANATICAL ABOUT YACHTS



LA MASCARADE

LA MASCARADE

BUILDER: Feadship

YEAR BUILT / REFIT: 1997 / 2014 / 2019

LOA: 30m / 98' 6"

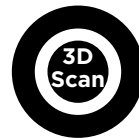

CECIL WRIGHT

FANATICAL ABOUT YACHTS



Exterior

LA MASCARADE

30M LEADSHIP



Main Salon

CECIL WRIGHT

FANATICAL ABOUT YACHTS



Master Cabin

LA MASCARADE

30M FEADSHIP



VIP Suite

CECIL WRIGHT

FANATICAL ABOUT YACHTS



VIP Bathroom

LA MASCARADE

30M FEADSHIP



Guest Cabin



Guest Cabin

LA MASCARADE

30M FEADSHIP



Sun Deck

CECIL WRIGHT

FANATICAL ABOUT YACHTS



Sun Deck

LA MASCARADE

30M FEADSHIP



Sun Deck

CECIL WRIGHT

FANATICAL ABOUT YACHTS

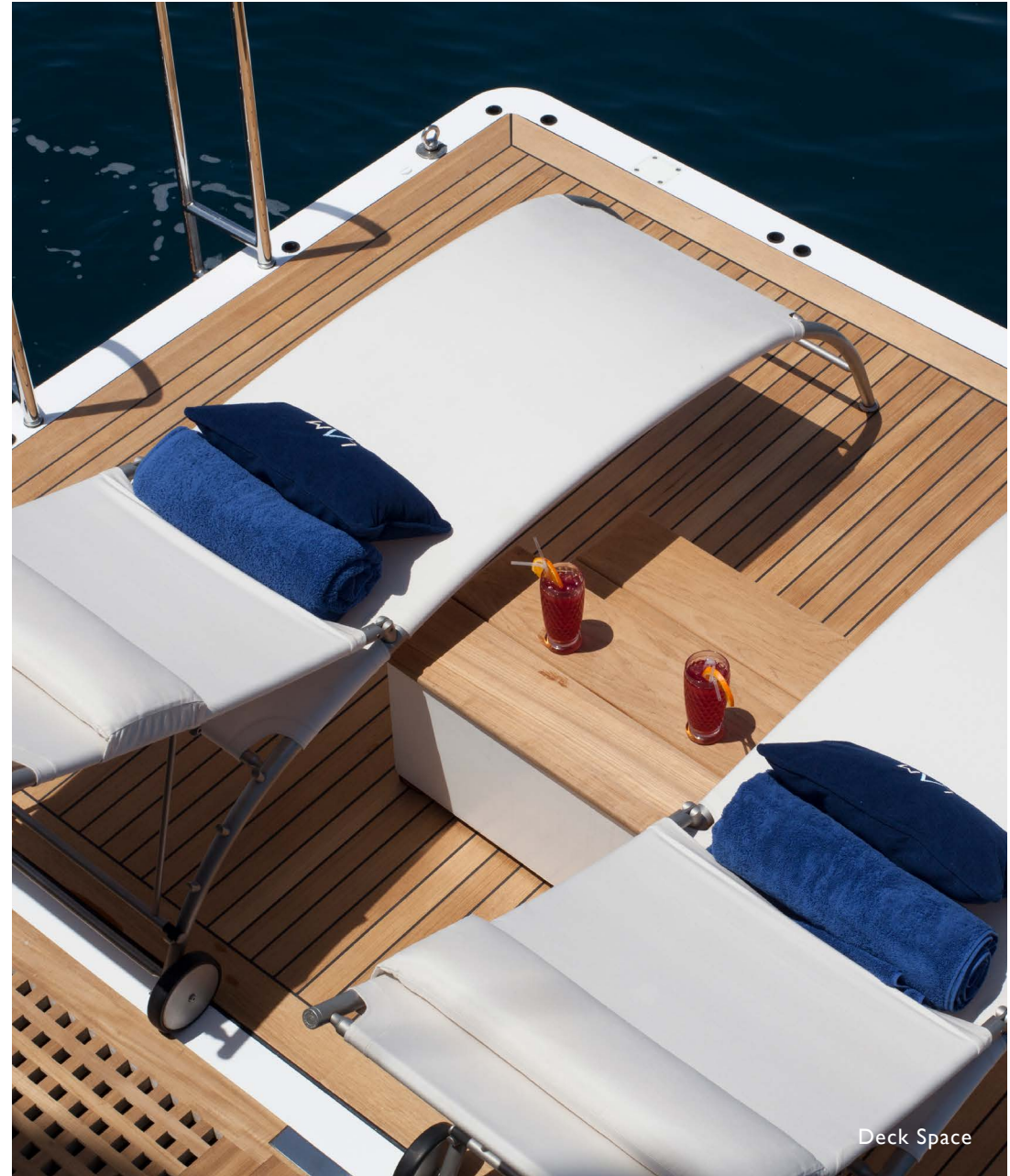

Deck Space

LA MASCARADE

30M FEADSHIP



Swim Up Platform

CECIL WRIGHT

FANATICAL ABOUT YACHTS



Swim Up Platform

LA MASCARADE

30M FEADSHIP



Exterior

CECIL WRIGHT

FANATICAL ABOUT YACHTS



Exterior

LA MASCARADE

30M FEADSHIP



Exterior

CECIL WRIGHT

FANATICAL ABOUT YACHTS

SUN DECK

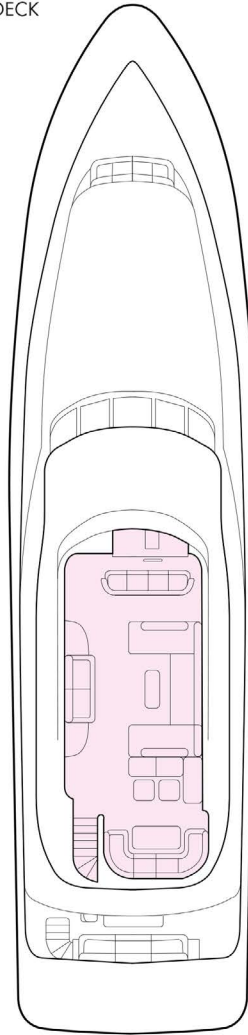

MAIN DECK

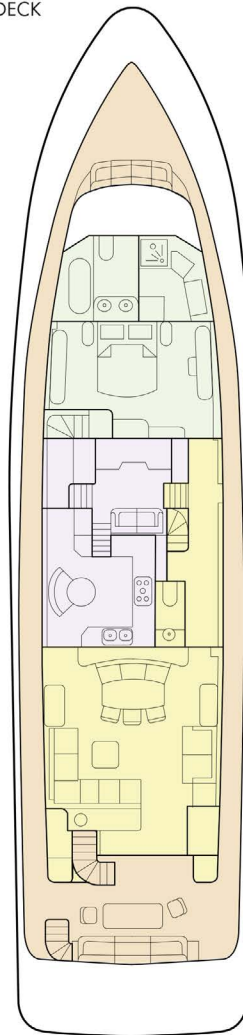

LOWER DECK

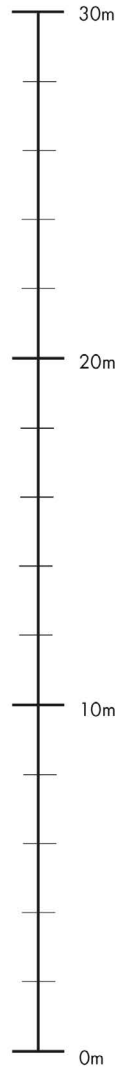
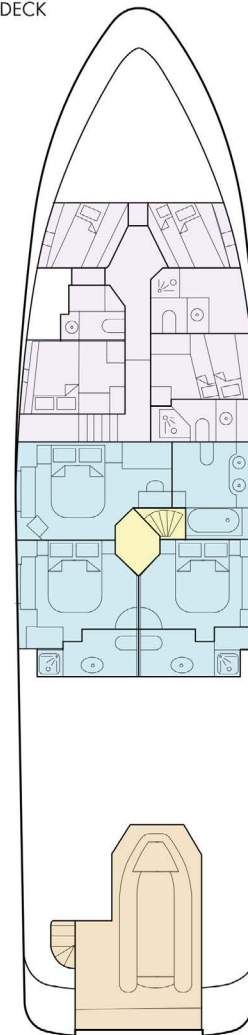

KEY

- Sun Deck
- Deck
- Guest Areas
- Master Cabin
- Guest Cabins
- Crew Areas

LA MASCARADE

30M FEADSHIP

MAIN SPECIFICATION

Name	LA MASCARADE (previously LA MASQUERADE)
Builder	Feadship, Royal Van Lent, Kaag (project 779)
Year Built (& refit years)	1997 (2014 2019)
Type	Semi Displacement, Twin Screw Diesel Motor Yacht
Classification	Lloyds, 100 A1, LY1, MCA compliant
Flag	Isle of Man
Designer	De Voogt Naval Architects
Naval Architect	De Voogt Naval Architects
Interior Designer	Terence Disdale
Hull & Superstructure	Awl Grip Snow white, Flag blue (all paint new 2019)
Bootstripe	Awl grip flag blue

CAPACITIES

Cruising Speed	12.5 knots
Maximum Speed	17.0 Knots
Range	1,492 nm @ 12.5 knots cruising speed 955nm @ 17.0 knots maximum speed
Fuel Capacity	23,480 Litres (approx. 6,203 US Gallons) + 395 Litres in day tank (approx. 104 US Gallons)
Fresh Water Capacity	7,380 Litres (approx. 1,950 US Gallons)
Black Water Capacity	900 Litres (approx. 238 US Gallons)
Grey Water Capacity	2,540 Litres (approx. 670 US Gallons)
Lube Oil Capacity	1,174 Litres (approx. 310 US Gallons)
Dirty Lube Oil	516 Litres (approx. 136 US Gallons)
Fuel Consumptions	12.5 knots, cruising speed, 200 l/hr 17.0 knots, maximum speed, 425 l/hr (Total consumption excludes 10 l/hr, per generator)

DIMENSIONS

Length O.A	30.00m / 98'6"
Length W.L	26.68 metres / 87' 6"
Beam	7.10 metres / 23' 4"
Draft	2.02 metres / 6' 8"
Gross Tonnage	190 GRT
Net Tonnage	57 NT
Displacement	140 MT (loaded)

SLEEPING

Guests	8 guests in 4 cabins
Crew	5-6 in 3 cabins

MACHINERY

General

Engines	Caterpillar
Engine Model	2 x C3412 2T6441 1250HP
Engine hours	Starboard, 6,481 hours (November-2019) SN: 3JK00589 Port: 6,470 hours (November-2019) SN: 3JK00583

Fuel	Diesel
Gearboxes	2 x ZF BW 255
Steering	Tenjford JR2. 130
Rudder Angle Indicators	Cplath
Stabilisers	Vosper Fin Stabilisers (underway) upgraded load sensing pump 2 x M26000 Seakeeper Gyros (Zero speed)
Propellers	2 x Lipps Fixed Pitch
Shafts	2 x Rubber Design Oil Bath system

Generators

Main Generator	2 x Caterpillar D3304 DIT Serial: Starboard: 83Z09497 & Port: 83Z09497
Main Generator hours	Starboard (80kW) 15,740 hours (November-2019) Port (50kW) 13,681 hours (November-2019)

LA MASCARADE

30M FEADSHIP

ACCOMMODATION

Batteries

Electricity	380v 3 phase
Shore Power	24V DC 220/380V AC Transformer auto syncro. on gens & shore power with load sharing, auto start and load sensor
Batteries	Gel – service, mains, radios

Air Conditioning

Make	Aqua Air
------	----------

Other Machinery

Water makers	2 x HEM Series 20 with a combined output of 200 litres/hour
Bow Thruster	Vosper VT40
Fuel Filters	Separ (2 per main engine) + 2 Separ per generator
Fuel Centrifugal Separator	Alfa Laval MMB 203 S13
Bilge Pump	Stork 3 phase + Stork 3 phase fire pump
Boilers	NibeElk
Sewage treatment	Hamann & Evac
WC's	Hamann & Evac
Water System	2 x Calpeda Frequency drive, HEM silver ioniser, UV treatment, sand filter
Hydraulics	Van Driel (crane (750kg swl), garage door, passerelle

Configuration

Owner	Full beam Stateroom forward with walk-through dressing area, ensuite bathroom with shower and jacuzzi bath, 2 sinks and toilets
Guest	1 x VIP cabin with walk-through dressing area and ensuite bathroom with double sink, bath with shower and toilet 2 x Double cabins with ensuite shower room
Crew	1 x Double Captain's cabin with ensuite shower room 4 x Twin upper and lower berth cabins with ensuite shower room

Owner's Suite

Owner's suite is located forward on the main deck, with natural light flooding through the large panoramic windows. Decorated in a classic yet contemporary style with a mixture of light wood, leather and fabric panelling and modern features. It boasts a king bed, walk-through dressing with full length mirrored doors into a light marble bathroom, with his and hers sinks, shower and a jacuzzi bath, and heated towel rails.

Guest Accommodation

Three further guest cabins are located on the lower deck;

1 x VIP cabin and 2 x Double cabins.

The VIP cabin has a large double bed, walk-through dressing with full length mirror and ensuite bathroom with his and her sinks, bath with shower.

The 2 x Double cabins have double beds, ensuite bathrooms with full size walk-in showers.

All three guest cabins are decorated in the same classic yet contemporary style, with a mixture of light wood, leather and fabric panelling.

Guest Areas

The main salon / interior dining is on the main deck. The interior has a simple, calm, contemporary design, giving a feeling of light, space and well-being, warmth, luxury and comfort.

Main deck aft has a dining table with seating (fixed furniture).

On the upper deck or sundeck, there is a large sofa / coffee table area which can be converted into a spacious sunbathing area, along with a removable awning and a teak dining table with a wrap-round bench and chairs.

LA MASCARADE also has a large swim platform and garage

Crew

Captain's Cabin is located on the lower deck

Crew cabins are also on the lower deck

Galley is on the main deck

Crew Mess is shared space in the galley on the main deck

Ship's Safe

1 in Owner's Suite

1 in Captain's Cabin

COMMUNICATIONS & NAVIGATION EQUIPMENT

Communications Equipment

VHF Radios

Furuno FM8850 and 2 x ICOM VHF,

1 x ICOM IC-M73 Euro

MacMurdo

AIS / GPS

Navigation Equipment

Gyro Compass

1 x Furuno Sat Compass

Magnetic Compass

1 x Sestral Major

Autopilot

1 x C. Path Navy Pilot V

Chart Plotter

1 x Transas Navi-Sailor 3000

Echo Sounder

1 x Furuno FCV620

Navtex

1 x Furuno navtex

DGPS

2 x Philips MK10

Radars

1 x Furuno FAR 2117 96nm

LA MASCARADE

30M FEADSHIP

DECK EQUIPMENT

Anchor Windlass	Steens Remote Controlled, 2 x Gypsies
Capstans	3 x Steens (2 aft and 1 forward)
Boarding Ladder	Marquip, aluminium/teak
Passerelle	1 x Akerboom (750kg)
Anchors	2 x 150kg HHP, POOL-N Certified
Anchor Chain	2 x 200m 14mm galvanised KENTER LINK
Ship's Bell	1 x Polished stainless-steel ship's bell of 300mm

TENDERS & WATERSPORTS EQUIPMENT

Tender

2015 RIB-X 4.75m Custom RIB (10 hours)

Watersports

2 x Donuts (2016-17)	1 x Wakeboard
2 x Waterskis	2 x Inflatable standup paddle boards
2 x Inflatable canoes	2 x Fishing rods

Snorkelling

Snorkelling equipment of various sizes onboard

ENTERTAINMENT & IT EQUIPMENT

General	VSat / Wi-Fi / areas Wifi throughout via Pepwave 4G sim card IT Server 1 x Microsoft home network, Apple TV
Owner's Stateroom	1 x 24" Samsung LED TV 1 x Apple TV 1 x Sky Box 1 x Sonos
VIP Cabin	1 x 40" Samsung LED TV 1 x Denon BluRay DVD/CD Receiver 1 x Sonos
Guest Double Cabins	1 x 20" Samsung LED TV 1 x Denon BluRay DVD/CD Receiver
Sundeck	2 x Bose 121 all-weather speakers 1 x Sonos
Main Deck Salon	1 x 70" Panasonic Oled TV 1 x Marantz surround sound amp 1 x Panasonic BluRay player 1 x Apple TV 1 x Sky Box 1 x Sonos

GALLEY & LAUNDRY EQUIPMENT

Main Galley	<ul style="list-style-type: none"> 1 x 90cm Bosch Oven 1 x Miele fridge/freezer 1 x Neff induction hob and extractor fan 2 x Miele under-cabinet fridges 1 x Miele microwave 1 x Osborne 160 drinks fridge 1 x Miele dishwasher 1 x Icemaker 1 x Mixer Magi Mix 3100 1 x Moulinex Optiblend 2000 1 x Nutri bullet 1 x Toaster
Sundeck	<ul style="list-style-type: none"> 1 x Deck fridge
Crew Area	<ul style="list-style-type: none"> 1 x Infrico professional fridge
Laundry	<ul style="list-style-type: none"> 1 x Miele 5424 Washing machine 1 x Miele T5226 Tumble dryer

SAFETY & SECURITY EQUIPMENT

Safety	<ul style="list-style-type: none"> 1 x Jason cradle, MOB Recovery equipment 14 x SOLAS Mediterranean type immersion suits 14 x Parat C 28 x Life jackets 4 x SOLAS life rings 4 x Children's life jackets 4 x Pairs Wessex line throwers 2 x Offshore flare packs 1 x Ocean Signal S100 Sart 1 x EPIRB ACR 2 x Handheld strobe 1 x Sanshin searchlight 2 x RFD 16-man liferafts
Fire Fighting	<ul style="list-style-type: none"> 1 x Firefighting CO₂ fixed station, 5 bottles x 20kg 15 x Fire extinguishers – dry powder and CO₂ 4 x Fire hydrant points with hoses and nozzles 1 x Fire pump with 1 x bilge/fire pump 1 x Emergency fire/bilge pump (diesel) 1 x Central fire alarm panel with 22 sensors 1 x Fire suit with berthing apparatus 1 x Pack ARI in engine room 1 x Spare 1 hour bottle 2 x Fire blankets

LA MASCARADE

30M FEADSHIP

Medical

Medical Kits
Cat-C Multiple Medical kit

Autopilot electronics replaced
New antifoul and anodes

Alarms

Praxis central alarm panel + Consillium
fire panel

Refit Work 2015

Security

CCTV Details
CCTV, Passerelle (1), Engine Room (3)

Freshwater tanks re-coated
New PLC for crane
New freshwater pump, frequency drives – replacing hydrophore
Galley refit

COMMENTS

Refit Work 2018/19
Full exterior re-paint

Port and starboard ensuites re-fitted
Praxis Alarm circuit board replaced
Exhaust insulation changed, replaced and re-finished with stainless steel
New antifoul and anodes

Refit Work 2017
New cabinetry for VIP cabin
Lloyds 5 year survey completed
Garage made petrol storage safe (flag & class approved)
Fire panel circuit board replaced

EXCLUSIONS

A complete list of exclusions is available upon request

Refit Work 2016
Bulwarks re-painted
Freshwater tanks re-coated
New satellite TV domes
Exterior tables stripped and re-finished
New cabinetry for guest cabins
Decks lightly sanded

Please note that the most recent imagery is to be found
on the 3D scan which was shot in November 2019.

CECIL WRIGHT

FANATICAL ABOUT YACHTS

LONDON

73 St James's Street
London
SW1A 1PH
+44 20 7408 1001

Chris Cecil-Wright
chris@cecilwright.com
+44 7920 557 837

MONACO

Le Mirabel
4 avenue des Citronniers
MC 98000
+377 97 98 76 60

Henry Smith
henry@cecilwright.com
+33 6 40 62 01 51

JERSEY

10 Hill St
St Helier
Jersey JE2 4UA
+44 1534 610 420

Matthew Ruane
matthew@cecilwright.com
+44 7797 722 024

www.cecilwright.com